

# TEST PIT LOCATION RECORDING FORM



Site Name/Code:

Test Pit number:

Test Pit Address:

Excavation date:

Surveyor:

Grid Reference:

Land owner, if different from surveyor:

## Sketch Plan of Test Pit Location

*Try to include the distances from as many fixed reference points as you can so that the test pit can be located accurately on the Ordnance Survey map.*



Measured by:

Plan drawn by:

When completed, please return to Heritage Lincolnshire via [htl@heritagelincs.org](mailto:htl@heritagelincs.org) or call 01529 461499 to discuss sharing your information.

Please ensure that you also submit your report to the Historic Environment Record, where your information will be made available on the internet through the Heritage Gateway and Lincs to the Past, ensuring that your findings will be shared with current and future generations. Call 01522 552363 or you can submit information by email to [lincsmr@lincolnshire.gov.uk](mailto:lincsmr@lincolnshire.gov.uk)

# TEST PIT CONTEXT RECORDING FORM



Site Name/Code:

Test Pit No.:

Context Number:

Context recorded by:

Depth .....m **1**

## CONTEXT PLAN

**2** Depth .....m

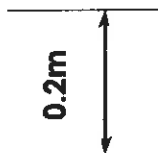

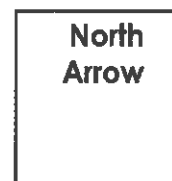
Depth .....m **4**

**3** Depth .....m

**Context Description**  
Describe soil type and list any inclusions such as stones, sand, clay, etc.

**Context Colour?**

**Photographed?**

**Sieved? .....%**

**List of Finds**  
List and describe any artefacts which came from this context.



